



# CHA35Q

## Charlotte LED Wall Sconce Down Light



| Dimensions |                |
|------------|----------------|
| Width (D)  | 18" (458mm)    |
| Length (B) | 7 1/8" (181mm) |
| Height (A) | 9 1/8" (232mm) |

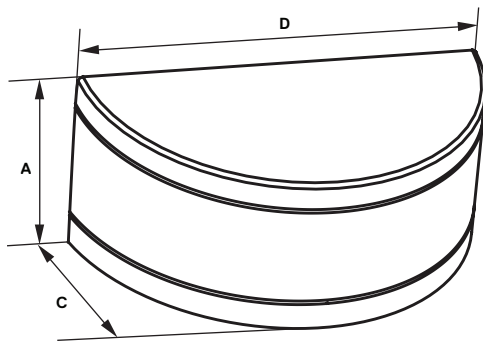

The SaySpec Charlotte CHA35Q cut-off architectural wall luminaire is available with IES IES Type III distribution designed to replace HID lighting systems from 150w to 250 MH or HPS. Typical wall mounted lighting applications include retail centers, industrial parks, schools and universities, public transit and airports, office buildings and medical facilities. Mounting heights of 12 to 20 feet can be used based on light level and uniformity requirements.

### SPECIFICATIONS AND FEATURES:

#### HOUSING:

Die Cast Aluminum Housing with Full Cutoff Front Frame. Nickel-Plated Stainless Steel Hardware.

#### LISTING & RATINGS:

CSA: Listed for Wet Locations, ANSI/UL 1598, 8750; IP65 Sealed LED Compartment.

#### FINISH:

Textured Bronze Powdercoat Finish Over a Chromate Conversion Coating. Custom Colors Available Upon Request.

#### LENS:

Tempered Clear Flat Glass Lens

#### MOUNTING OPTIONS:

Mount Directly Over a 4" Recessed Outlet Box, Includes Easy-Hang "Two Hands Free" Wall Mounting Bracket with Built-In Level.

#### LED:

Aluminum Boards; 347,000 Hours of L70 LED Life (25°C)

#### WATTAGE:

Array: 46.5w, System: 52w; (250w HID Equivalent)

#### DRIVER:

Electronic Driver, 120-277V, 50/60Hz or 347-480V, 50/60Hz; Less Than 20% THD and PF>0.90. Standard Internal Surge Protection 6kV. 0-10V Dimming Standard for a Dimming Range of 100% to 10%; Dimming Source Current is 150 Microamps.

#### CONTROLS:

Fixtures Ordered with Factory-Installed Photocell or Motion Sensor Controls are Internally Wired for Switching and/or 1-10V Dimming Within the Housing. Remote Direct Wired Interface of 1-10V Dimming is Not Implied and May Not Be Available, Please Consult Factory. Fixtures are Tested with SaySpec Controls and May Not Function Properly With Controls Supplied By Others. Fixtures are NOT Designed for Use with Line Voltage Dimmers.

#### WARRANTY:

5-Year Warranty for -40°C to +40°C Environment.

See Page 2 for Projected Lumen Maintenance Table.

#### Order Information Example:

CHA35QC1X47U5KCZSP

| CHA35Q                                       | C          | 1X47     |                          |                                  | C                       |   |   |
|--|------------|----------|--------------------------|----------------------------------|-------------------------|---|---|
| Model  | Optics     | Wattage  | Driver                   | CCT                              | Lens                    | Color                                     | Options   |
| CHA35Q= Charlotte LED Wall Sconce Down Light | C=Type III | 1X47=47w | U=120-277V<br>H=347-480V | 3K=3000K<br>4K=4000K<br>5K=5000K | C=Clear Flat Glass Lens | Z=Bronze<br>C=Custom<br>(Consult Factory) | SF*=Single Fuse (120-277V Only)<br>DF*=Double Fuse (120-277V Only)<br>SP=Surge Protection<br>PC3*=Photocell, 120-277VAC<br>BU*=Battery Backup, 90 Mins<br>BUC*=Cold Start Battery Backup, -20°C, 90 Mins<br><br>*120-277V Models Only |

#### Project Information:

PROJECT NAME: \_\_\_\_\_ FIXTURE TYPE: \_\_\_\_\_

COMPLETE CATALOG#: \_\_\_\_\_ DATE: \_\_\_\_\_

COMMENTS: \_\_\_\_\_

#### Certification & Listings:



ACCESSORIES & REPLACEMENT PARTS:



| Replacement Parts<br>(Order Separately, Field Installed) |                                |
|--|--------------------------------|
| WP35GLC  | Tempered Clear Flat Glass Lens |
| P18100   | 120VAC Photocell               |
| P18103   | 120-277VAC Photocell           |

PHOTOMETRIC DATA

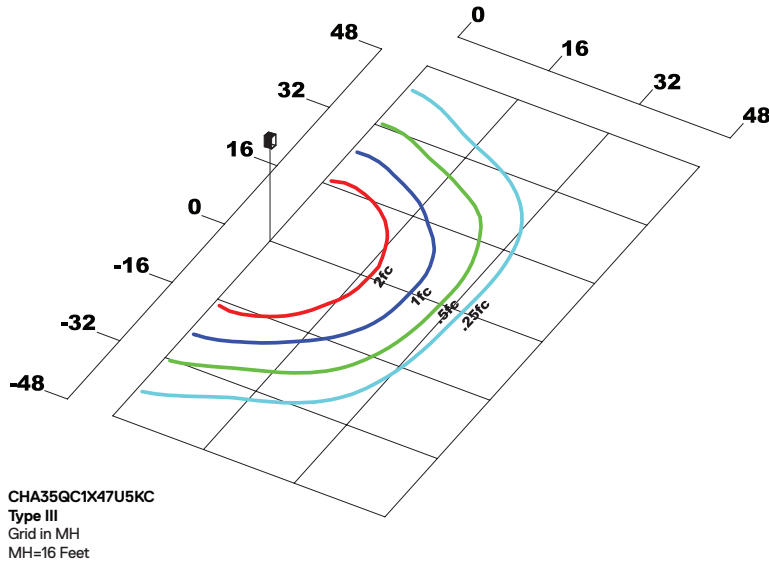

PHOTOMETRIC PERFORMANCE

| LED Board Watts | Drive Current (mA) | Input Watts | Optics   | 5000 CCT 80 CRI |     |   |   |   | 4000 CCT 80 CRI |     |   |   |   |
|-----------------|--------------------|-------------|----------|-----------------|-----|---|---|---|-----------------|-----|---|---|---|
|                 |                    |             |          | Lumens          | LPW | B | U | G | Lumens          | LPW | B | U | G |
| LED 47w         | 525                | 52          | Type III | 4,921           | 95  | 1 | 1 | 1 | 4,503           | 87  | 1 | 1 | 1 |

PROJECTED LUMEN MAINTENANCE

| Data shown for 5000 CCT              |             |         | Compare to MH |            |             |                      |  |
|--------------------------------------|-------------|---------|---------------|------------|-------------|----------------------|--|
| TM-21-11                             | Input Watts | Initial | 25,000 Hrs    | 50,000 Hrs | 100,000 Hrs | Calculated L70@ 25°C |  |
| L70 Lumen Maintenance @ 25°C / 77°F  | 52          | 1.00    | 0.98          | 0.96       | 0.91        | 347,000              |  |
| TM-21-11                             | Input Watts | Initial | 25,000 Hrs    | 50,000 Hrs | 100,000 Hrs | Calculated L70@ 50°C |  |
| L70 Lumen Maintenance @ 50°C / 122°F | 52          | 1.00    | 0.96          | 0.91       | 0.82        | 168,000              |  |
| TM-21-11                             | Input Watts | Initial | 25,000 Hrs    | 50,000 Hrs | 100,000 Hrs | Calculated L80@ 40°C |  |
| L80 Lumen Maintenance @ 40°C / 104°F | 52          | 1.00    | 0.97          | 0.94       | 0.88        | 160,000              |  |

NOTES:  
 1. Projected per IESNA TM-21-11. Data references the extrapolated performance projections for the 525mA base model in a 25°C ambient, based on 10,000 hours of LED testing per IESNA LM-80-08.  
 2. Compare to MH box indicates suggested Light Loss Factor (LLF) to be used when comparing to Metal Halide (MH) systems.