



JOB NAME:

CAT#:

TYPE:

**APPLICATIONS**

**The Fan**

Make a statement in your space with a number of configurations of our PGN23 (polygon 2"x3") series hanging luminaire system, including The Fan shown here. Whether developing your own custom pattern of L23 fixtures or choosing from multiple standard patterns, the PGN23 series delivers with elegance and distinction.

To achieve this symmetric, radial configuration, The Fan has been engineered with special brackets for popular L23 fixtures. The Fan casts bright, white and energy efficient illumination. Instantly transform the look and feel of your space with these inventive and refreshing fixtures that are suited for applications in need of both up and down lighting as options.

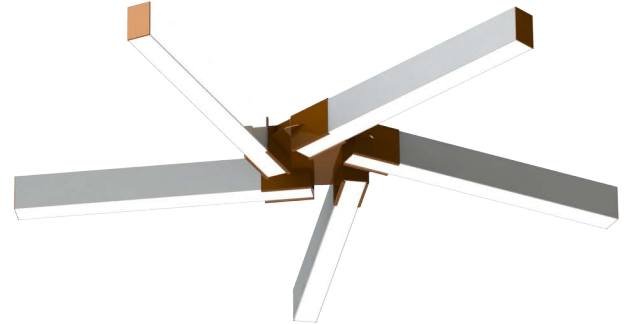

**FEATURES & BENEFITS**

- 3 standard bracket configurations – 3, 5, and 6 fixtures
- Customizable bracket colors available
- Pendant mount for most ceilings
- Many lumen package / wattage options via programmable drivers
- CRI >80 (90 CRI available)
- >50,000 hrs of L70 LED life
- Power factor >0.90

**DIMENSIONS**

Part	D	D = Diameter
PGN23-P51	51"	
PGN23-P99	99"	
PGN23-P147	147"	

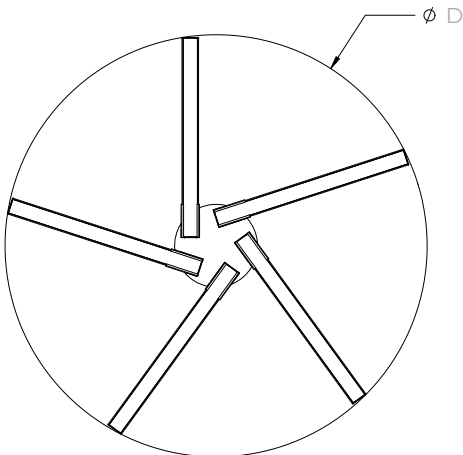
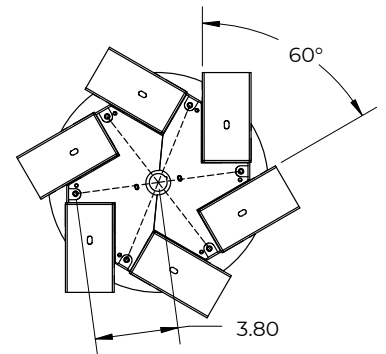
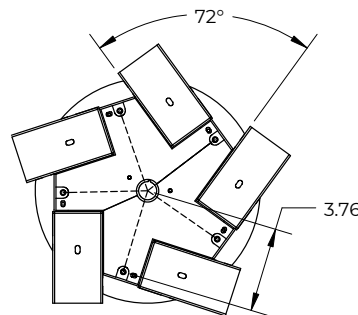
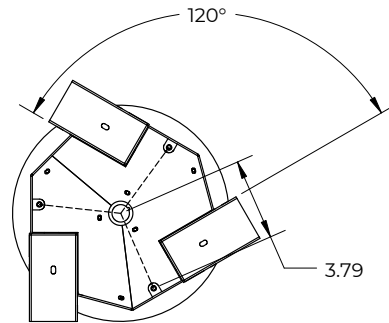

Dimensions and specifications subject to change without notice.



JOB NAME:

CAT#:

TYPE:

**ORDERING**

EXAMPLE: PGN23 P 51 LED 60 DMV BK FR 30 RD EM14 -F3

**PGN23**

**P**

**LED**

1. SERIES	2. MOUNTING	3. DIAMETER <sup>1</sup>	4. GEAR	5. DISTRIBUTION	6. WATTAGE/LUMENS <sup>2</sup>	7. DRIVER
<b>PGN23</b>	<b>P</b> Pendant	<b>51</b> 51" <b>99</b> 99" <b>147</b> 147"	<b>LED</b>	<b>Blank</b> Downlight (std.) <b>1U2D</b> Uplight and Downlight	<p><b>Downlight</b> <b>51 in.</b></p> <p><b>60</b> 60 Watts 6900 Lumens(F3) <b>100</b> 100 Watts 11500 Lumens(F5) <b>120</b> 120 Watts 13800 Lumens(F6)</p> <p><b>99 in.</b></p> <p><b>120</b> 120 Watts 13800 Lumens(F3) <b>200</b> 200 Watts 23000 Lumens(F5) <b>240</b> 240 Watts 27600 Lumens(F6)</p> <p><b>147 in.</b></p> <p><b>180</b> 180 Watts 20700 Lumens(F3) <b>300</b> 300 Watts 34500 Lumens(F5) <b>360</b> 360 Watts 41400 Lumens(F6)</p> <p><b>1 Up and 2 Down Only</b> <b>51 in.</b></p> <p><b>96</b> 96 Watts 4140U-6900D(F3) <b>160</b> 160 Watts 6900U-11500D(F5) <b>192</b> 192 Watts 8280U-13800D(F6)</p> <p><b>99 in.</b></p> <p><b>192</b> 192 Watts 8280U-13800D(F3) <b>320</b> 320 Watts 13800U-23000D(F5) <b>384</b> 384 Watts 16560U-27600D(F6)</p> <p><b>147 in.</b></p> <p><b>288</b> 288 Watts 12420U-20700D(F3) <b>480</b> 480 Watts 20700U-34500D(F5) <b>576</b> 576 Watts 28840U-41400D (F6)</p>	<p><b>DMV</b> 120-277V Multivolt 0-10V Dimmable</p> <p><b>DMVII</b> 0-10V Dimming Separate drivers for uplight and downlight</p>
8. FINISH <sup>3</sup>	9. LENS	10. CRI	11. COLOR TEMP	12. FLAIR <sup>4</sup>	13. EM (O) <sup>5</sup>	14. CONFIGURATION
<b>BK</b> Black <b>SI</b> Silver <b>WH</b> White	<b>FR</b> Frosted Acrylic Lens (85% transmission)	<b>Blank</b> 80 <b>9</b> 90	<b>30</b> 3000K <b>35</b> 3500K <b>40</b> 4000K <b>50</b> 5000K	<b>RD</b> Red <b>BL</b> Blue <b>BK</b> Matte Black	<b>EM14</b> 14W Emergency Battery Backup <sup>5</sup>	<b>-F3</b> 3 Fixture Fan <b>-F5</b> 5 Fixture Fan <b>-F6</b> 6 Fixture Fan

**Notes:**

<sup>1</sup>Fan configurations are measured by an overall system diameter.

<sup>2</sup>Wattage and lumen values are total for the system. Minimum fixture wattage of 10W. Minimum 5W per fixture foot uplight and downlight. Maximum 7W per fixture foot uplight and 14W per fixture foot downlight. Power feed cable is 18AWG, power drop is required every 800W or 48 feet for 0-10V dimming, whichever comes first.

<sup>3</sup>Consult for custom finish options

<sup>4</sup>Consult for custom flair options

<sup>5</sup>Emergency battery backup is integrated in fixtures 4' and longer, but is not available in fixtures 4' and shorter if uplight and downlight are used.

<sup>6</sup>(O) is optional

Dimensions and specifications subject to change without notice.



JOB NAME:

CAT#:

TYPE:

**FLAIR BRACKET COLORS AND FINISHES**



Gloss Black  
(GB)



Matte Black  
(BK)



Matte Silver  
(SL)

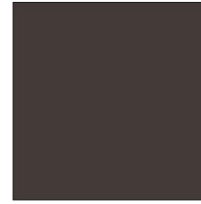

Statuary Bronze  
(BZ)

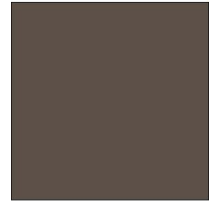

Glimmer (Iron)  
(IR)

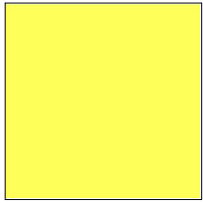

Safety Yellow  
(YL)

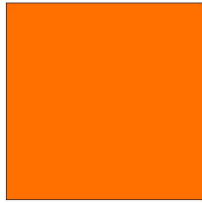

Safety Orange  
(OR)



Red  
(RD)



Fire Engine Red  
(FR)



Blue  
(BL)

**NOTE:** Factory offers any Tiger Drylac RAL finish, contact Saylite for more information. Consult factory for information on specialty "real wood" finishes.

Dimensions and specifications subject to change without notice.



JOB NAME:

CAT#:

TYPE:

### APPLICATIONS

#### The Triangle

Make a statement in your space with a number of configurations of our PGN23 (polygon 2"x3") series hanging luminaire system, including The Triangle shown here. Whether developing your own custom pattern of L23 fixtures or choosing from multiple standard patterns, the PGN23 series delivers with elegance and distinction.

To design this equilateral triangle configuration, The Triangle has been specifically engineered with special brackets for popular L23 fixtures. The Triangle provides bright, white and energy efficient illumination with uplight and downlight options. Instantly transform the look and feel of your space with these inventive and refreshing fixtures.

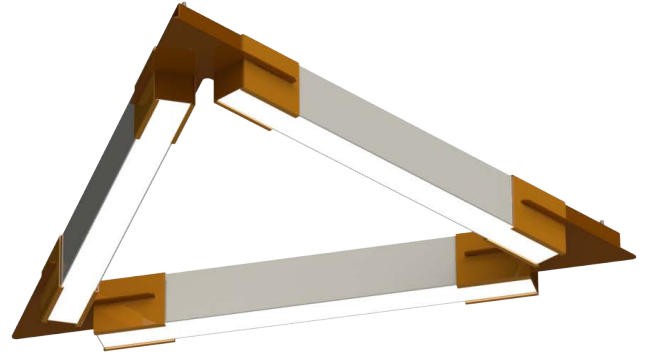

### FEATURES & BENEFITS

- 4 standard fixture sizes – 24" , 48" , 72" , and 96"
- Customizable bracket colors available
- Pendant mount for most ceilings
- Many lumen package / wattage options via programmable drivers
- CRI >80 (90 CRI available)
- >50,000 hrs of L70 LED life
- Power factor >0.90

### DIMENSIONS

Part	W	L	X	Y	Z
PGN23-P30X35	30"	35"	31"	27"	16"
PGN23-P51X59	51"	59"	55"	48"	28"
PGN23-P72X83	72"	83"	79"	69"	40"
PGN23-P93X107	93"	107"	103"	90"	52"

#### HANGING KIT ATTACHMENT POINTS

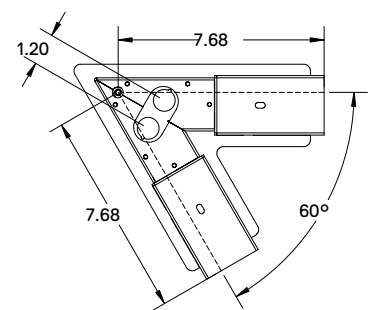
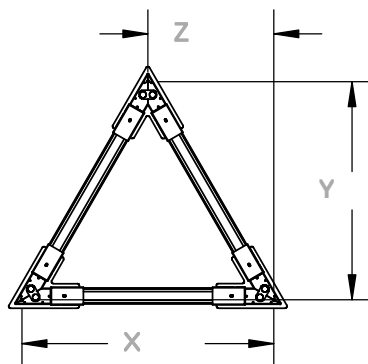
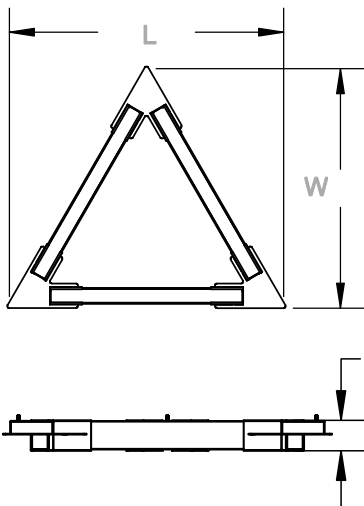

Dimensions and specifications subject to change without notice.





JOB NAME:

CAT#:

TYPE:

**ORDERING**

EXAMPLE: PGN23-P 51x59 LED 120 DMV BK FR 30 RD EM14 -TR

**PGN23 — P**

**LED**

1. SERIES	2. MOUNTING	3. WIDTH X LENGTH <sup>1</sup>	4. GEAR	5. DISTRIBUTION	6. WATTAGE/LUMENS <sup>2</sup>	7. DRIVER
<b>PGN23</b>	<b>P</b> Pendant	<b>30X35</b> 30"W x 35"L	<b>LED</b>	<b>Blank</b> Downlight (std.)	<b>60</b> 60 Watts 6900 Lumens	<b>DMV</b> 120-277V Multivolt 0-10V Dimmable
		<b>51X59</b> 51"W x 59"L				
		<b>72X83</b> 72"W x 83"L		<b>180</b> 180 Watts 20700 Lumens		
		<b>93X107</b> 93"W x 107"L			<b>240</b> 240 Watts 27600 Lumens	
					<b>DMV11</b> 0-10V Dimming Separate drivers for uplight and downlight	
					<b>1 Up and 2 Down Only</b>	
					<b>30X35 in.</b>	
					<b>96</b> 96 Watts 4140U-6900D	
					<b>51X59 in.</b>	
					<b>192</b> 192 Watts 8280U-13800D	
					<b>72X83 in.</b>	
					<b>288</b> 288 Watts 12420U-120700D	
					<b>93X107 in.</b>	
					<b>384</b> 384 Watts 16560U-27600D	

8. FINISH <sup>3</sup>	9. LENS	10. CRI	11. COLOR TEMP	12. FLAIR <sup>4</sup>	13. EM (O) <sup>5</sup>	14. CONFIGURATION
<b>BK</b> Black	<b>FR</b> Frosted Acrylic Lens (85% transmission)	<b>Blank</b> 80	<b>30</b> 3000K	<b>RD</b> Red	<b>EM14</b> 14W Emergency Battery Backup <sup>5</sup>	<b>-TR</b> Triangle
<b>SI</b> Silver		<b>9</b> 90	<b>35</b> 3500K			
<b>WH</b> White			<b>40</b> 4000K			
			<b>50</b> 5000K	<b>BL</b> Blue		
				<b>BK</b> Matte Black		

**Notes:**

- <sup>1</sup>Triangle configurations are measured by an overall system width and length.
- <sup>2</sup>Wattage and lumen values are total for the system. Minimum fixture wattage of 10W. Minimum 5W per fixture foot uplight and downlight. Maximum 7W per fixture foot uplight and 14W per fixture foot downlight. Power feed cable is 18AWG, power drop is required every 800W or 48 feet for 0-10V dimming, whichever comes first.
- <sup>3</sup>Consult for custom finish options
- <sup>4</sup>Consult for custom flair options
- <sup>5</sup>Emergency battery backup is integrated in fixtures 4' and longer, but is not available in fixtures 4' and shorter if uplight and downlight are used.
- <sup>6</sup>(O) is optional

Dimensions and specifications subject to change without notice.



JOB NAME:

CAT#:

TYPE:

**FLAIR BRACKET COLORS AND FINISHES**



Gloss Black  
(GB)



Matte Black  
(BK)

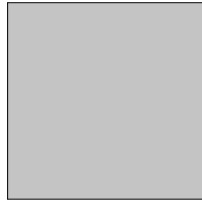

Matte Silver  
(SL)

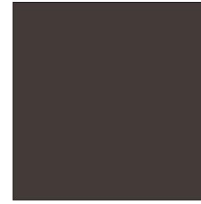

Statuary Bronze  
(BZ)

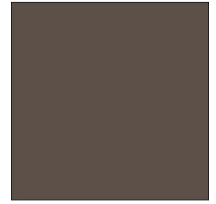

Glimmer (Iron)  
(IR)

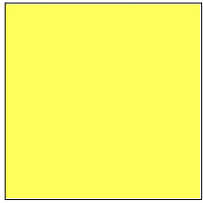

Safety Yellow  
(YL)

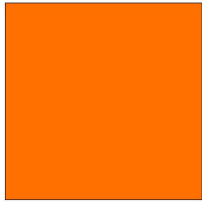

Safety Orange  
(OR)



Red  
(RD)



Fire Engine Red  
(FR)



Blue  
(BL)

**NOTE:** Factory offers any Tiger Drylac RAL finish, contact Saylite for more information. Consult factory for information on specialty "real wood" finishes.

Dimensions and specifications subject to change without notice.



JOB NAME:

CAT#:

TYPE:

### APPLICATIONS

#### The Square/Rectangle

Make a statement in your space with a number of configurations of our PGN23 (polygon 2"x3") series hanging luminaire system, including The Square/Rectangle shown here. Whether developing your own custom pattern of L23 fixtures or choosing from multiple standard patterns, the PGN23 series delivers with elegance and distinction.

To design square and rectangle configurations, these luminaires have been engineered with special brackets for popular L23 fixtures. The Square/Rectangle provides bright, white and energy efficient illumination with uplight and downlight options. Instantly transform the look and feel of your space with these inventive and refreshing fixtures.

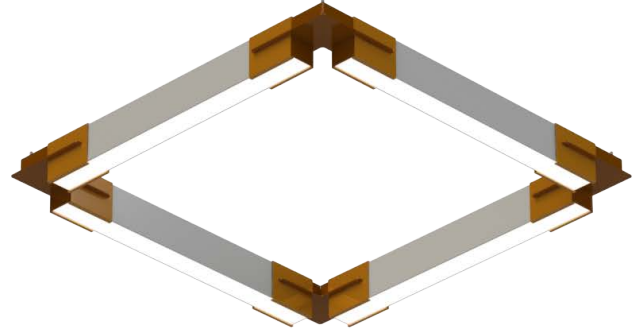

### FEATURES & BENEFITS

- 4 standard fixture lengths – 24", 48", 72", and 96"
- Customizable bracket colors available
- Pendant mount for most ceilings
- Many lumen package / wattage options via programmable drivers
- CRI >80 (90 CRI available)
- >50,000 hrs of L70 LED life
- Power factor >0.90

### DIMENSIONS

Part	W	L	X	Y
PGN23-P32X32	32"	32"	29"	29"
PGN23-P56X56	56"	56"	53"	53"
PGN23-P80X80	80"	80"	77"	77"
PGN23-P104X104	104"	104"	101"	101"

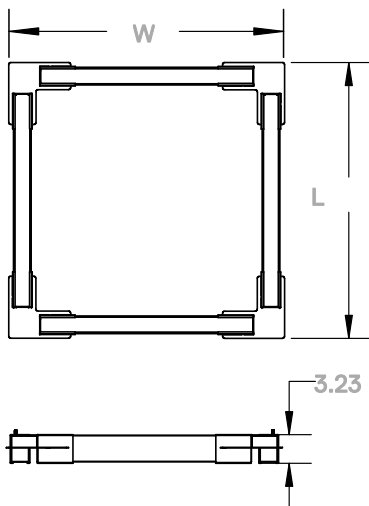

HANGING KIT ATTACHMENT POINTS

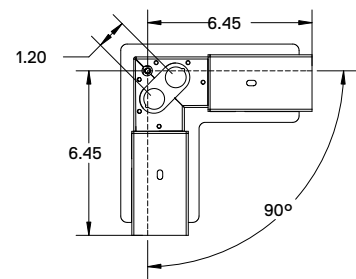
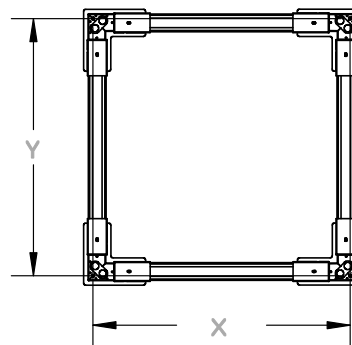

Dimensions and specifications subject to change without notice.





JOB NAME:

CAT#:

TYPE:

**ORDERING**

EXAMPLE: PGN23-P 80X80 LED 240 DMV BK FR 30 RD EM14 -SQ

**PGN23 — P**

**LED**

1. SERIES	2. MOUNTING	3. WIDTH X LENGTH <sup>1</sup>	4. GEAR	5. DISTRIBUTION	6. WATTAGE/LUMENS <sup>2</sup>	7. DRIVER	
<b>PGN23</b>	<b>P</b> Pendant	<b>32X32</b> 32"W x 32"L	<b>LED</b>	<b>Blank</b> Downlight (std.)	<b>Downlight</b> <b>32X32 in.</b>	<b>DMV</b> 120-277V Multivolt 0-10V Dimmable	
		<b>56X56</b> 56"W x 56"L					<b>80</b> 80 Watts 9200 Lumens
		<b>80X80</b> 80"W x 80"L					
		<b>104X104</b> 104"W x 104"L					<b>1U2D</b> Uplight and Downlight
		<b>240</b> 240 Watts 27600 Lumens <b>104X104 in.</b>					
		<b>320</b> 320 Watts 36800 Lumens <b>1 Up and 2 Down Only</b> <b>32X32 in.</b>					
		<b>128</b> 128 Watts 5520U-9200D <b>56X56 in.</b>					
		<b>256</b> 256 Watts 11040U-18400D <b>80X80 in.</b>					
		<b>384</b> 384 Watts 16560U-27600D <b>104X10 in.</b>					
					<b>512</b> 512 Watts 22080U-36800D		

8. FINISH <sup>3</sup>	9. LENS	10. CRI	11. COLOR TEMP	12. FLAIR <sup>4</sup>	13. EM (O) <sup>5</sup>	14. CONFIGURATION
<b>BK</b> Black	<b>FR</b> Frosted Acrylic Lens (85% transmission)	<b>Blank</b> 80	<b>30</b> 3000K	<b>RD</b> Red	<b>EM14</b> 14W Emergency Battery Backup <sup>5</sup>	<b>-SQ</b> Square
<b>SI</b> Silver		<b>9</b> 90	<b>35</b> 3500K	<b>BL</b> Blue		<b>-RT</b> Rectangle
<b>WH</b> White			<b>40</b> 4000K	<b>BK</b> Matte Black		
			<b>50</b> 5000K			

**Notes:**

<sup>1</sup>Square/rectangle configurations are measured by an overall system width and length.

<sup>2</sup>Wattage and lumen values are total for the system. Minimum fixture wattage of 10W. Minimum 5W per fixture foot uplight and downlight. Maximum 7W per fixture foot uplight and 14W per fixture foot downlight. Power feed cable is 18AWG, power drop is required every 800W or 48 feet for 0-10V dimming, whichever comes first.

<sup>3</sup>Consult for custom finish options

<sup>4</sup>Consult for custom flair options

<sup>5</sup>Emergency battery backup is integrated in fixtures 4' and longer, but is not available in fixtures 4' and shorter if uplight and downlight are used.

<sup>6</sup>(O) is optional

Dimensions and specifications subject to change without notice.





JOB NAME:

CAT#:

TYPE:

**FLAIR BRACKET COLORS AND FINISHES**



Gloss Black  
(GB)



Matte Black  
(BK)



Matte Silver  
(SL)

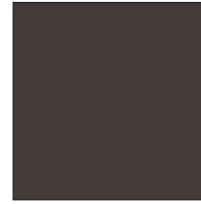

Statuary Bronze  
(BZ)

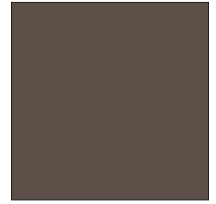

Glimmer (Iron)  
(IR)

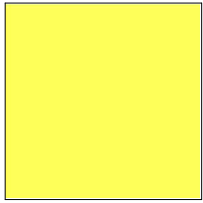

Safety Yellow  
(YL)

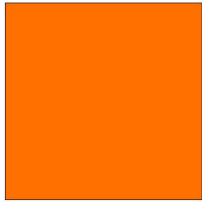

Safety Orange  
(OR)



Red  
(RD)



Fire Engine Red  
(FR)



Blue  
(BL)

**NOTE:** Factory offers any Tiger Drylac RAL finish, contact Saylite for more information. Consult factory for information on specialty "real wood" finishes.

Dimensions and specifications subject to change without notice.



JOB NAME:

CAT#:

TYPE:

### APPLICATIONS

#### The Pentagon

Make a statement in your space with a number of configurations of our PGN23 (polygon 2"x3") series hanging luminaire system, including The Pentagon shown here. Whether developing your own custom pattern of L23 fixtures or choosing from multiple standard patterns, the PGN23 series delivers with elegance and distinction.

To achieve this symmetric, 5-sided configuration, The Pentagon has been engineered with special brackets for popular L23 fixtures. The Pentagon casts bright, white and energy efficient illumination with uplight and downlight options. Instantly transform the look and feel of your space with these inventive and refreshing fixtures.

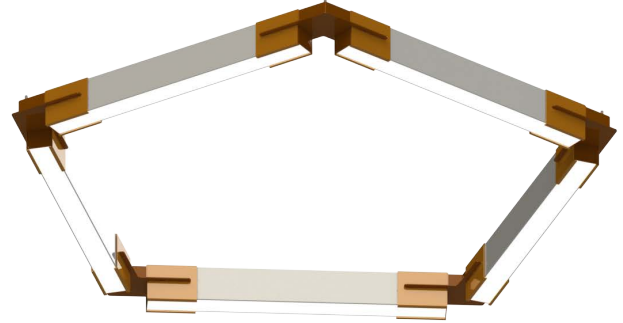

### FEATURES & BENEFITS

- 4 standard fixture lengths – 24", 48", 72", and 96"
- Customizable bracket colors available
- Pendant mount for most ceilings
- Many lumen package / wattage options via programmable drivers
- CRI >80 (90 CRI available)
- >50,000 hrs of L70 LED life
- Power factor >0.90

### DIMENSIONS

Part	D	Y <sub>1</sub>	Y <sub>2</sub>	Z <sub>1</sub>	Z <sub>2</sub>
PGN23-P69	57"	29"	44"	9"	14"
PGN23-P109	92"	53"	81"	16"	26"
PGN23-P157	133"	77"	118"	24"	38"
PGN23-P205	174"	101"	155"	31"	50"

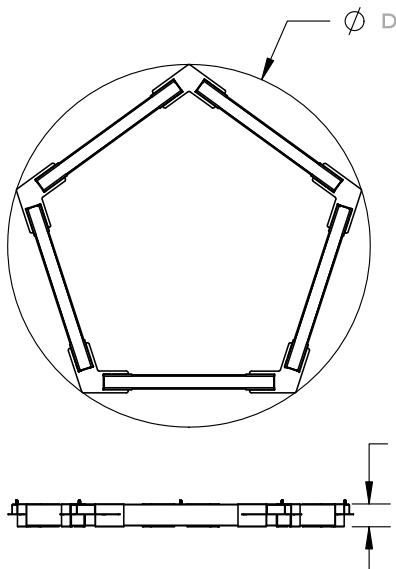

HANGING KIT ATTACHMENT POINTS

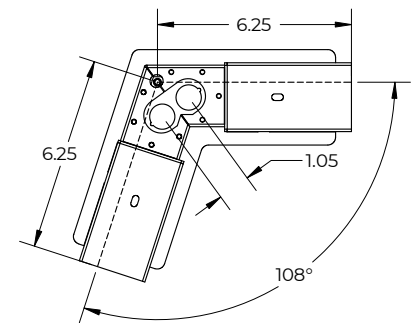
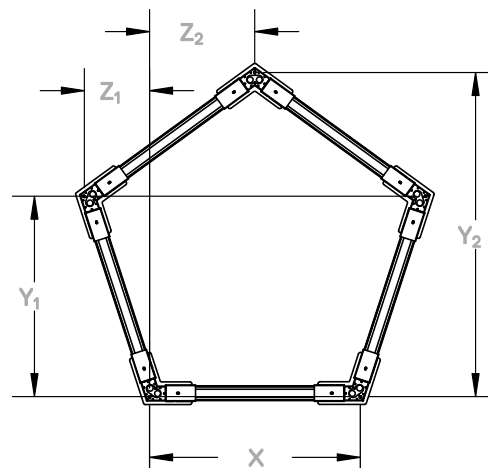

Dimensions and specifications subject to change without notice.





JOB NAME:

CAT#:

TYPE:

**ORDERING**

EXAMPLE: PGN23-P 92 LED 1U2D 320 DMV BK FR 30 RD EM14 -PT

**PGN23 — P**

**LED**

1. SERIES	2. MOUNTING	3. DIAMETER <sup>1</sup>	4. GEAR	5. DISTRIBUTION	6. WATTAGE/LUMENS <sup>2</sup>	7. DRIVER			
PGN23	P Pendant	57 57"	LED	Blank Downlight (std.)	<b>Downlight</b> 57 in.	DMV 120-277V Multivolt 0-10V Dimmable			
		92 92"					1U2D Uplight and Downlight	100 100 Watts 11500 Lumens	
		133 133"						200 200 Watts 23000 Lumens	
		174 174"						300 300 Watts 34500 Lumens	
		<b>1 Up and 2 Down Only</b>						400 400 Watts 46000 Lumens	
								160 160 Watts 6900U-11500D	
								320 320 Watts 13800U-23000D	
								480 480 Watts 20700U-34500D	
								640 640 Watts 27600U-46000D	
								DMV11 0-10V Dimming Separate drivers for uplight and downlight	

8. FINISH <sup>3</sup>	9. LENS	10. CRI	11. COLOR TEMP	12. FLAIR <sup>4</sup>	13. EM (O) <sup>5</sup>	14. CONFIGURATION
BK Black	FR Frosted Acrylic Lens (85% transmission)	Blank 80	30 3000K	RD Red	EM14 14W Emergency Battery Backup <sup>5</sup>	-PT Pentagon
SI Silver		9 90	35 3500K	BL Blue		
WH White			40 4000K	BK Matte Black		
			50 5000K			

**Notes:**

<sup>1</sup>Pentagon configurations are measured by an overall system diameter.

<sup>2</sup>Wattage and lumen values are total for the system. Minimum fixture wattage of 10W. Minimum 5W per fixture foot uplight and downlight. Maximum 7W per fixture foot uplight and 14W per fixture foot downlight. Power feed cable is 18AWG, power drop is required every 800W or 48 feet for 0-10V dimming, whichever comes first.

<sup>3</sup>Consult for custom finish options

<sup>4</sup>Consult for custom flair options

<sup>5</sup>Emergency battery backup is integrated in fixtures 4' and longer, but is not available in fixtures 4' and shorter if uplight and downlight are used.

<sup>6</sup>(O) is optional

Dimensions and specifications subject to change without notice.



JOB NAME:

CAT#:

TYPE:

**FLAIR BRACKET COLORS AND FINISHES**



Gloss Black  
(GB)



Matte Black  
(BK)



Matte Silver  
(SL)

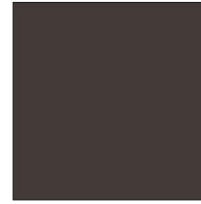

Statuary Bronze  
(BZ)

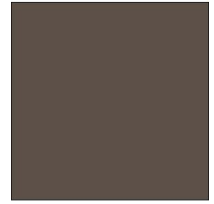

Glimmer (Iron)  
(IR)

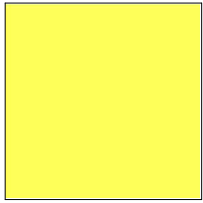

Safety Yellow  
(YL)

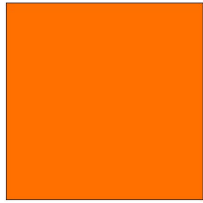

Safety Orange  
(OR)



Red  
(RD)



Fire Engine Red  
(FR)



Blue  
(BL)

**NOTE:** Factory offers any Tiger Drylac RAL finish, contact Saylite for more information. Consult factory for information on specialty "real wood" finishes.

Dimensions and specifications subject to change without notice.



JOB NAME:

CAT#:

TYPE:

### APPLICATIONS

#### The Hexagon

Make a statement in your space with a number of configurations of our PGN23 (polygon 2"x3") series hanging luminaire system, including The Hexagon shown here. Whether developing your own custom pattern of L23 fixtures or choosing from multiple standard patterns, the PGN23 series delivers with elegance and distinction.

To achieve this symmetric, 6-sided configuration, The Hexagon has been engineered with special brackets for popular L23 fixtures. The Hexagon casts bright, white and energy efficient illumination with uplight and downlight options. Instantly transform the look and feel of your space with these inventive and refreshing fixtures.

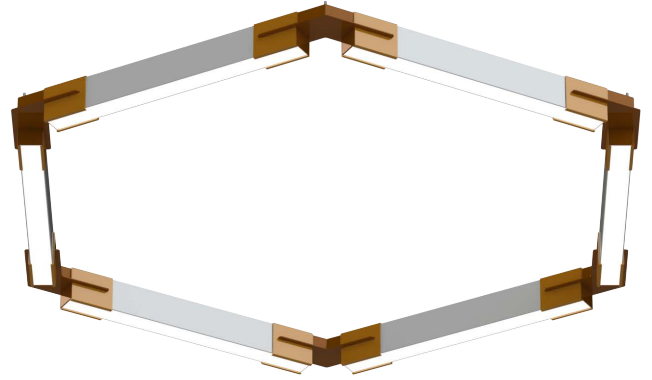

### FEATURES & BENEFITS

- 4 standard fixture lengths – 24", 48", 72", and 96"
- Customizable bracket colors available
- Pendant mount for most ceilings
- Many lumen package / wattage options via programmable drivers
- CRI >80 (90 CRI available)
- >50,000 hrs of L70 LED life
- Power factor >0.90

### DIMENSIONS

Part	D	X	Y	Z
PGN23-P69	69"	29"	25"	15"
PGN23-P109	109"	53"	46"	27"
PGN23-P157	157"	77"	67"	39"
PGN23-P205	205"	101"	88"	51"

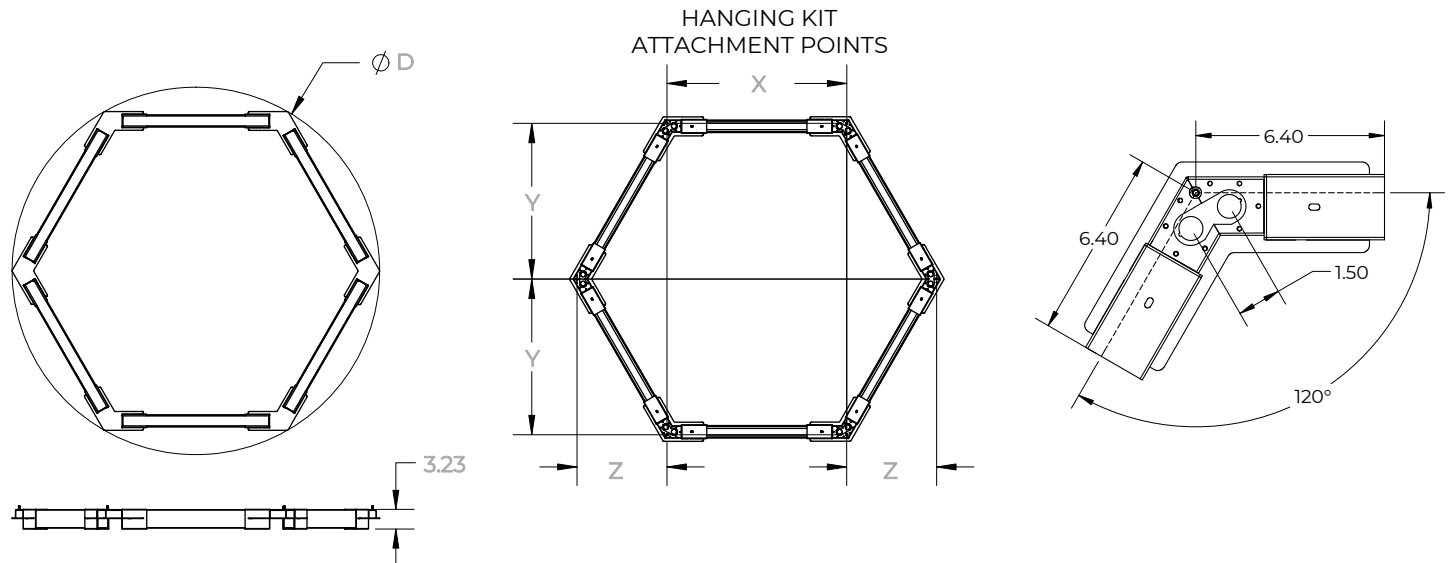

Dimensions and specifications subject to change without notice.







JOB NAME:

CAT#:

TYPE:

**FLAIR BRACKET COLORS AND FINISHES**



Gloss Black  
(GB)



Matte Black  
(BK)



Matte Silver  
(SL)

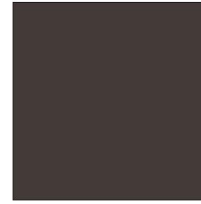

Statuary Bronze  
(BZ)

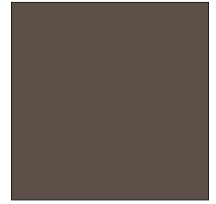

Glimmer (Iron)  
(IR)

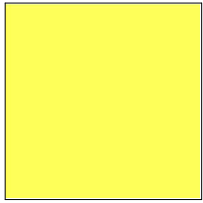

Safety Yellow  
(YL)

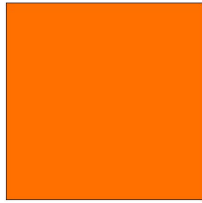

Safety Orange  
(OR)



Red  
(RD)



Fire Engine Red  
(FR)



Blue  
(BL)

**NOTE:** Factory offers any Tiger Drylac RAL finish, contact Saylite for more information. Consult factory for information on specialty "real wood" finishes.

Dimensions and specifications subject to change without notice.



JOB NAME:

CAT#:

TYPE:

### APPLICATIONS

#### The Octagon

Make a statement in your space with a number of configurations of our PGN23 (polygon 2"x3") series hanging luminaire system, including The Octagon shown here. Whether developing your own custom pattern of L23 fixtures or choosing from multiple standard patterns, the PGN23 series delivers with elegance and distinction.

To achieve this symmetric, 8-sided configuration, The Octagon has been engineered with special brackets for popular L23 fixtures. The Octagon casts bright, white and energy efficient illumination with uplight and downlight options. Instantly transform the look and feel of your space with these inventive and refreshing fixtures.

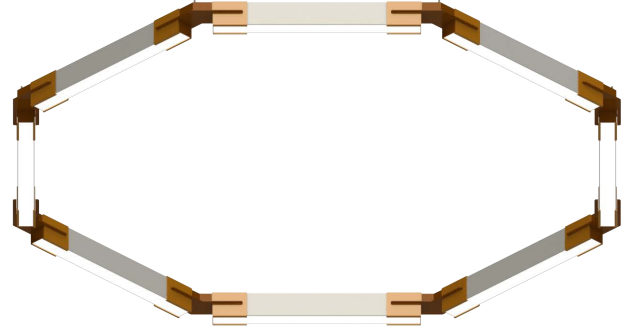

### FEATURES & BENEFITS

- 4 standard fixture sizes – 24" , 48" , 72" , and 96"
- Customizable bracket colors available
- Pendant mount for most ceilings
- Many lumen package / wattage options via programmable drivers
- CRI >80 (90 CRI available)
- >50,000 hrs of L70 LED life
- Power factor >0.90

### DIMENSIONS

Part	D	X	Y	Z
PGN23-P69	77"	28"	20"	20"
PGN23-P109	203"	52"	37"	37"
PGN23-P157	223"	76"	54"	54"
PGN23-P205	265"	100"	71"	71"

### HANGING KIT ATTACHMENT POINTS

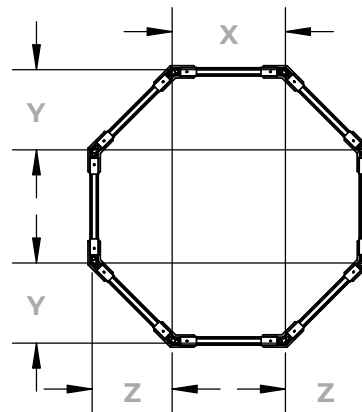
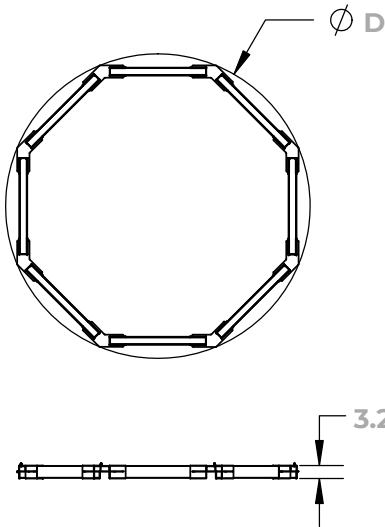

Dimensions and specifications subject to change without notice.







JOB NAME:

CAT#:

TYPE:

**ORDERING**

EXAMPLE: PGN23 P 223 LED 480 DMV BK FR 30 RD EM14-OT

**PGN23**

**P**

**LED**

1. SERIES	2. MOUNTING	3. DIAMETER <sup>1</sup>	4. GEAR	5. DISTRIBUTION	6. WATTAGE/LUMENS <sup>2</sup>	7. DRIVER
<b>PGN23</b>	<b>P</b> Pendant	<b>77</b> 77" <b>203</b> 203" <b>223</b> 223" <b>265</b> 265"	<b>LED</b>	<b>Blank</b> Downlight (std.) <b>1U2D</b> Uplight and Downlight	<b>Downlight</b> <b>77 in.</b> <b>160</b> 160 Watts 18400 Lumens <b>203 in.</b> <b>320</b> 320 Watts 36800 Lumens <b>223 in.</b> <b>480</b> 480 Watts 55200 Lumens <b>265 in.</b> <b>640</b> 640 Watts 73600 Lumens  <b>1 Up and 2 Down Only</b> <b>77 in.</b> <b>256</b> 256 Watts 11040U-18400D <b>203 in.</b> <b>512</b> 512 Watts 22080U-36800D <b>223 in.</b> <b>768</b> 768 Watts 33120U-55200D <b>265 in.</b> <b>1024</b> 1024 Watts 44160U-73600D	<b>DMV</b> 120-277V Multivolt 0-10V Dimmable  <b>DMV11</b> 0-10V Dimming Separate drivers for uplight and downlight

8. FINISH <sup>3</sup>	9. LENS	10. CRI	11. COLOR TEMP	12. FLAIR <sup>4</sup>	13. EM (O) <sup>5</sup>	14. CONFIGURATION
<b>BK</b> Black <b>SI</b> Silver <b>WH</b> White	<b>FR</b> Frosted Acrylic Lens (85% transmission)	<b>Blank</b> 80 <b>9</b> 90	<b>30</b> 3000K <b>35</b> 3500K <b>40</b> 4000K <b>50</b> 5000K	<b>RD</b> Red <b>BL</b> Blue <b>BK</b> Matte Black	<b>EM14</b> 14W Emergency Battery Backup <sup>5</sup>	<b>-F3</b> 3 Fixture Fan <b>-F5</b> 5 Fixture Fan <b>-F6</b> 6 Fixture Fan

**Notes:**

<sup>1</sup>Octagon configurations are measured by an overall system diameter.

<sup>2</sup>Wattage and lumen values are total for the system. Minimum fixture wattage of 10W. Minimum 5W per fixture foot uplight and downlight. Maximum 7W per fixture foot uplight and 14W per fixture foot downlight. Power feed cable is 18AWG, power drop is required every 800W or 48 feet for 0-10V dimming, whichever comes first. Two power drops required when 96" fixtures are used.

<sup>3</sup>Consult for custom finish options

<sup>4</sup>Consult for custom flair options

<sup>5</sup>Emergency battery backup is integrated in fixtures 4' and longer, but is not available in fixtures 4' and shorter if uplight and downlight are used.

<sup>6</sup>(O) is optional

Dimensions and specifications subject to change without notice.



JOB NAME:

CAT#:

TYPE:

**FLAIR BRACKET COLORS AND FINISHES**



Gloss Black  
(GB)



Matte Black  
(BK)

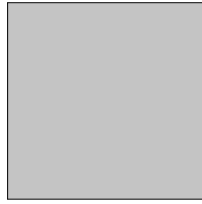

Matte Silver  
(SL)

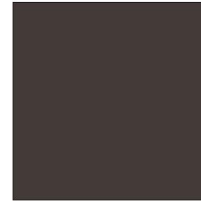

Statuary Bronze  
(BZ)

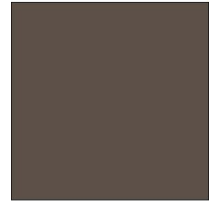

Glimmer (Iron)  
(IR)

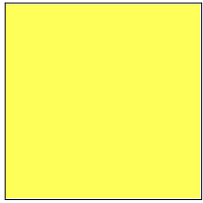

Safety Yellow  
(YL)

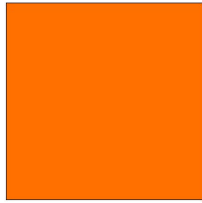

Safety Orange  
(OR)



Red  
(RD)



Fire Engine Red  
(FR)



Blue  
(BL)

**NOTE:** Factory offers any Tiger Drylac RAL finish, contact Saylite for more information. Consult factory for information on specialty "real wood" finishes.

Dimensions and specifications subject to change without notice.



JOB NAME:

CAT#:

TYPE:

## APPLICATIONS

### The Parallel

Make a statement in your space with a number of configurations of our PGN23 (polygon 2"x3") series hanging luminaire system, including The Parallel configuration shown here. Whether developing your own custom pattern of L23 fixtures or choosing from multiple standard patterns, the PGN23 series delivers with elegance and distinction.

The Parallel fixtures have been engineered with special brackets for linear parallel configurations of popular L23 fixtures. The Parallel provides bright, white and energy efficient illumination with uplight and downlight options. Instantly transform the look and feel of your space with these inventive and refreshing fixtures.



## FEATURES & BENEFITS

- 4 standard fixture lengths – 24" , 48" , 72" , and 96"
- Customizable bracket colors available
- Pendant mount for most ceilings
- Many lumen package / wattage options via programmable drivers
- CRI >80 (90 CRI available)
- >50,000 hrs of L70 LED life
- Power factor >0.90

## DIMENSIONS

Part	W	L
PGN23-P9X29	9"	29"
PGN23-P9X53	9"	53"
PGN23-P9X77	9"	77"
PGN23-P9X101	9"	101"

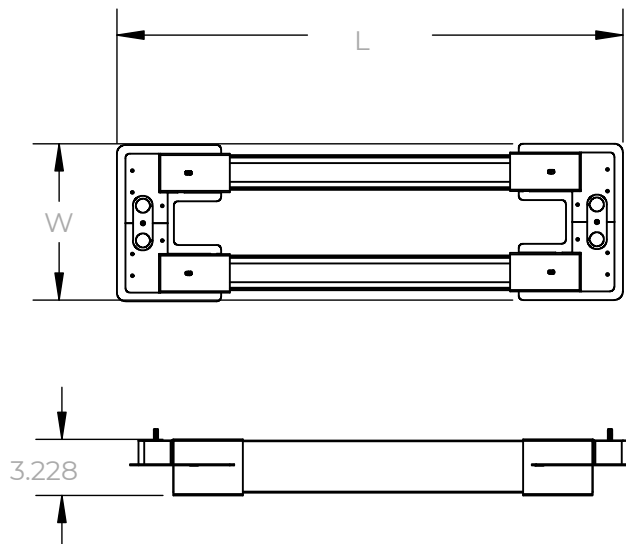

Dimensions and specifications subject to change without notice.





JOB NAME:

CAT#:

TYPE:

**ORDERING**

EXAMPLE: PGN23-P 9X29 LED 40 DMV BK FR 30 RD EM14 -P

**PGN23 — P**

**LED**

1. SERIES	2. MOUNTING	3. WIDTH X LENGTH <sup>1</sup>	4. GEAR	5. DISTRIBUTION	6. WATTAGE/LUMENS <sup>2</sup>	7. DRIVER			
<b>PGN23</b>	<b>P</b> Pendant	<b>9X29</b> 9"W x 29"L	<b>LED</b>	<b>Blank</b> Downlight (std.)	<b>40</b> 40 Watts 9200 Lumens	<b>DMV</b> 120-277V Multivolt 0-10V Dimmable			
		<b>9X53</b> 9"W x 53"L							
		<b>9X77</b> 9"W x 77"L							
		<b>9X101</b> 9"W x 101"L							
<b>PGN23</b>	<b>P</b> Pendant	<b>9X29</b> 9"W x 29"L	<b>LED</b>	<b>1U2D</b> Uplight and Downlight	<b>80</b> 80 Watts 18400 Lumens	<b>DMV11</b> 0-10V Dimming Separate drivers for uplight and downlight			
				<b>40</b> 40 Watts 9200 Lumens			<b>Downlight</b> <b>32X32 in.</b>		
							<b>55X56 in.</b>		
							<b>80X80 in.</b>		
<b>PGN23</b>	<b>P</b> Pendant	<b>9X29</b> 9"W x 29"L	<b>LED</b>	<b>Blank</b> Downlight (std.)	<b>120</b> 120 Watts 27600 Lumens	<b>DMV11</b> 0-10V Dimming Separate drivers for uplight and downlight			
							<b>120</b> 120 Watts 27600 Lumens	<b>104X104 in.</b>	
								<b>160</b> 160 Watts 36800 Lumens	<b>1 Up and 2 Down Only</b> <b>32X32 in.</b>
									<b>64</b> 64 Watts 2760U-4600D
<b>PGN23</b>	<b>P</b> Pendant	<b>9X29</b> 9"W x 29"L	<b>LED</b>	<b>Blank</b> Downlight (std.)	<b>128</b> 128 Watts 5520U-9200D	<b>DMV11</b> 0-10V Dimming Separate drivers for uplight and downlight			
							<b>128</b> 128 Watts 5520U-9200D	<b>80X80 in.</b>	
								<b>192</b> 192 Watts 8280U-13800D	<b>104X10 in.</b>
									<b>256</b> 256 Watts 11040U-18400D

8. FINISH <sup>3</sup>	9. LENS	10. CRI	11. COLOR TEMP	12. FLAIR <sup>4</sup>	13. EM (O) <sup>5</sup>	14. CONFIGURATION
<b>BK</b> Black	<b>FR</b> Frosted Acrylic Lens (85% transmission)	<b>Blank</b> 80	<b>30</b> 3000K	<b>RD</b> Red	<b>EM14</b> 14W Emergency Battery Backup <sup>5</sup>	<b>-P</b> Parallel
<b>SI</b> Silver		<b>9</b> 90	<b>35</b> 3500K			
<b>WH</b> White			<b>40</b> 4000K			
			<b>50</b> 5000K	<b>BL</b> Blue		
				<b>BK</b> Matte Black		

**Notes:**

- <sup>1</sup>Parallel configurations are measured by an overall system width and length.
- <sup>2</sup>Wattage and lumen values are total for the system. Minimum fixture wattage of 10W. Minimum 5W per fixture foot uplight and downlight. Maximum 7W per fixture foot uplight and 14W per fixture foot downlight. Power feed cable is 18AWG, power drop is required every 800W or 48 feet for 0-10V dimming, whichever comes first.
- <sup>3</sup>Consult for custom finish options
- <sup>4</sup>Consult for custom flair options
- <sup>5</sup>Emergency battery backup is integrated in fixtures 4' and longer, but is not available in fixtures 4' and shorter if uplight and downlight are used.
- <sup>6</sup>(O) is optional

Dimensions and specifications subject to change without notice.



JOB NAME:

CAT#:

TYPE:

**FLAIR BRACKET COLORS AND FINISHES**



Gloss Black  
(GB)



Matte Black  
(BK)



Matte Silver  
(SL)

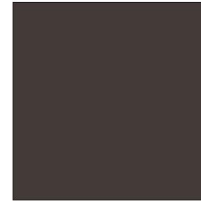

Statuary Bronze  
(BZ)

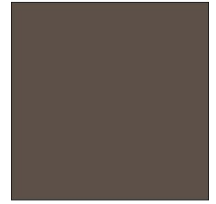

Glimmer (Iron)  
(IR)

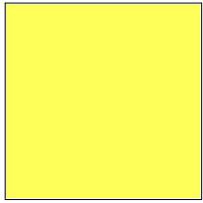

Safety Yellow  
(YL)

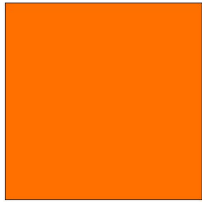

Safety Orange  
(OR)



Red  
(RD)



Fire Engine Red  
(FR)



Blue  
(BL)

**NOTE:** Factory offers any Tiger Drylac RAL finish, contact Saylite for more information. Consult factory for information on specialty "real wood" finishes.

Dimensions and specifications subject to change without notice.



JOB NAME:

CAT#:

TYPE:

### APPLICATIONS

#### The Wall Wash

Make a statement in your space with a number of configurations of our PGN23 (polygon 2"x3") series hanging luminaire system, including The Wall Wash shown here. Whether developing your own custom pattern of L23 fixtures or choosing from multiple standard patterns, the PGN23 series delivers with elegance and distinction.

To achieve this 2-angled configuration, The Wall Wash has been engineered with special brackets for popular L23 fixtures. It casts bright, white and energy efficient illumination. Instantly transform the look and feel of your space with these inventive and refreshing fixtures.

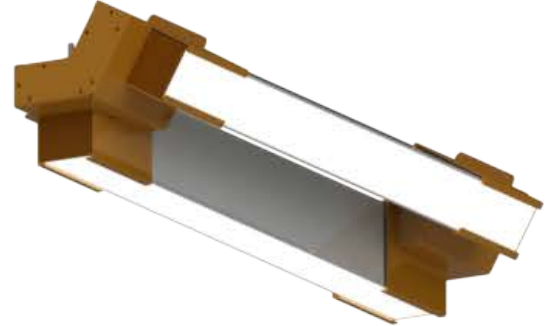

### FEATURES & BENEFITS

- 4 standard fixture lengths – 24", 48", 72", and 96"
- Customizable bracket colors available
- Pendant mount for most ceilings
- Many lumen package / wattage options via programmable drivers
- CRI >80 (90 CRI available)
- >50,000 hrs of L70 LED life
- Power factor >0.90

### DIMENSIONS

Part	W	L	L <sub>H</sub>
PGN23-P32X32	6"	27"	26"
PGN23-P56X56	6"	51"	50"
PGN23-P80X80	6"	75"	74"
PGN23-P104X104	6"	99"	98"

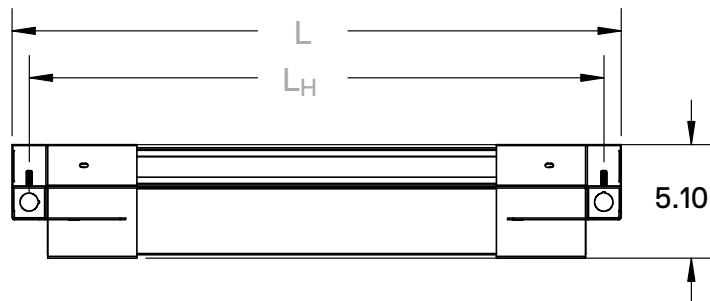
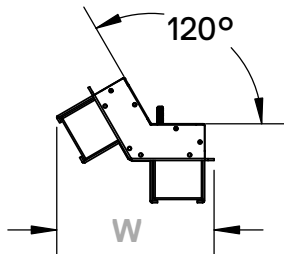

Consult factory for different angle options.

Dimensions and specifications subject to change without notice.





JOB NAME:

CAT#:

TYPE:

**ORDERING**

EXAMPLE: PGN23-P 6X27 LED 40 DMV BK FR 30 RD EM14 -WW

**PGN23 — P**

**LED**

1. SERIES	2. MOUNTING	3. WIDTH X LENGTH <sup>1</sup>	4. GEAR	5. DISTRIBUTION	6. WATTAGE/LUMENS <sup>2</sup>	7. DRIVER
<b>PGN23</b>	<b>P</b> Pendant	<b>6X27</b> 6"W x 27"L <b>6X51</b> 6"W x 51"L <b>6X75</b> 6"W x 75"L <b>6X99</b> 6"W x 99"L	<b>LED</b>	<b>Blank</b> Downlight (std.) <b>1U2D</b> Uplight and Downlight	<b>Downlight</b> <b>32X32 in.</b> <b>40</b> 40 Watts 9200 Lumens <b>55X56 in.</b> <b>80</b> 80 Watts 18400 Lumens <b>80X80 in.</b> <b>120</b> 120 Watts 27600 Lumens <b>104X104 in.</b> <b>160</b> 160 Watts 36800 Lumens <b>1 Up and 2 Down Only</b> <b>32X32 in.</b> <b>52</b> 64 Watts 1380U-4600D <b>56X56 in.</b> <b>104</b> 128 Watts 2760U-9200D <b>80X80 in.</b> <b>156</b> 192 Watts 4140U-13800D <b>104X10 in.</b> <b>208</b> 256 Watts 5520U-18400D	<b>DMV</b> 120-277V Multivolt 0-10V Dimmable  <b>DMV11</b> 0-10V Dimming Separate drivers for uplight and downlight

8. FINISH <sup>3</sup>	9. LENS	10. CRI	11. COLOR TEMP	12. FLAIR <sup>4</sup>	13. EM (O) <sup>5</sup>	14. CONFIGURATION
<b>BK</b> Black <b>SI</b> Silver <b>WH</b> White	<b>FR</b> Frosted Acrylic Lens (85% transmission)	<b>Blank</b> 80 <b>9</b> 90	<b>30</b> 3000K <b>35</b> 3500K <b>40</b> 4000K <b>50</b> 5000K	<b>RD</b> Red <b>BL</b> Blue <b>BK</b> Matte Black	<b>EM14</b> 14W Emergency Battery Backup <sup>5</sup>	<b>-WW</b> Wall Wash

**Notes:**

- <sup>1</sup>Wall wash configurations are measured by an overall system width and length.
- <sup>2</sup>Wattage and lumen values are total for the system. Uplight available on vertical fixture only. Minimum fixture wattage of 10W. Minimum 5W per fixture foot uplight and downlight. Maximum 7W per fixture foot uplight and 14W per fixture foot downlight. Power feed cable is 18AWG, power drop is required every 800W or 48 feet for 0-10V dimming, whichever comes first.
- <sup>3</sup>Consult for custom finish options
- <sup>4</sup>Consult for custom flair options
- <sup>5</sup>Emergency battery backup is integrated in fixtures 4' and longer, but is not available in fixtures 4' and shorter if uplight and downlight are used.
- <sup>6</sup>(O) is optional

Dimensions and specifications subject to change without notice.



JOB NAME:

CAT#:

TYPE:

**FLAIR BRACKET COLORS AND FINISHES**



Gloss Black  
(GB)



Matte Black  
(BK)



Matte Silver  
(SL)

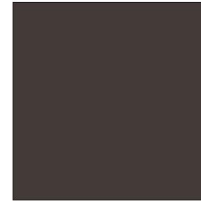

Statuary Bronze  
(BZ)

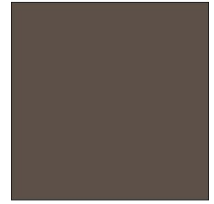

Glimmer (Iron)  
(IR)

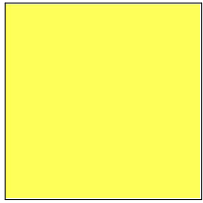

Safety Yellow  
(YL)

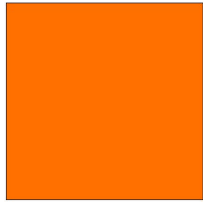

Safety Orange  
(OR)



Red  
(RD)



Fire Engine Red  
(FR)



Blue  
(BL)

**NOTE:** Factory offers any Tiger Drylac RAL finish, contact Saylite for more information. Consult factory for information on specialty "real wood" finishes.

Dimensions and specifications subject to change without notice.





JOB NAME:

CAT#:

TYPE:

### APPLICATIONS

#### The Cross

Make a statement in your space with a number of configurations of our PGN23 (polygon 2"x3") series hanging luminaire system, including The Cross shown here. Whether developing your own custom pattern of L23 fixtures or choosing from multiple standard patterns, the PGN23 series delivers with elegance and distinction.

To achieve this X-shaped configuration, The Cross has been engineered with special brackets for popular L23 fixtures. The Cross casts bright, white and energy efficient illumination.. Instantly transform the look and feel of your space with these inventive and refreshing fixtures.

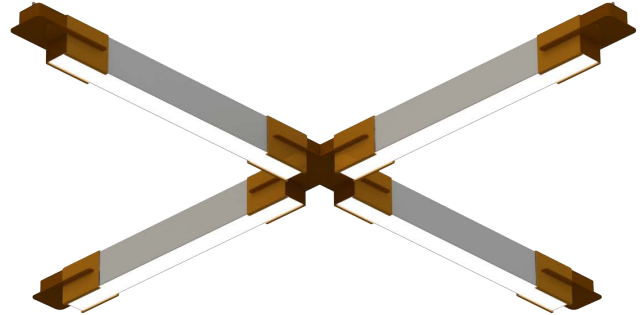

### FEATURES & BENEFITS

- 4 standard fixture lengths – 24" , 48" , 72" , and 96"
- Customizable bracket colors available
- Pendant mount for most ceilings
- Many lumen package / wattage options via programmable drivers
- CRI >80 (90 CRI available)
- >50,000 hrs of L70 LED life
- Power factor >0.90

### DIMENSIONS

Part	W	L
PGN23-P60X60	60"	60"
PGN23-P108X108	108"	108"
PGN23-P156X156	156"	156"
PGN23-P204X204	204"	204"

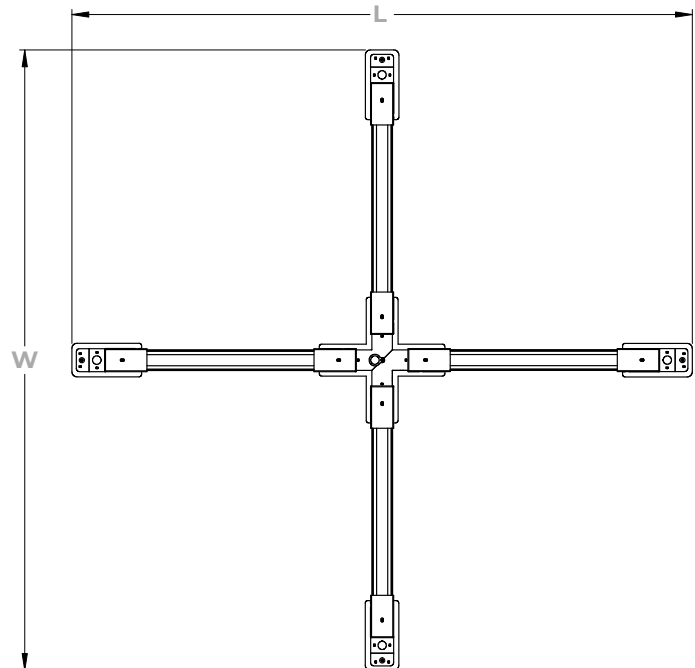

Dimensions and specifications subject to change without notice.





JOB NAME:

CAT#:

TYPE:

**ORDERING**

EXAMPLE: PGN23 P 60X60 LED 240 DMV BK FR 30 RD EM14 -CR

**PGN23**

**P**

**LED**

1. SERIES	2. MOUNTING	3. WIDTH X LENGTH <sup>1</sup>	4. GEAR	5. DISTRIBUTION	6. WATTAGE/LUMENS <sup>2</sup>	7. DRIVER
<b>PGN23</b>	<b>P</b> Pendant	<b>60X60</b> 60"W x 60"L <b>108X108</b> 108"W x 108"L <b>156X156</b> 156"W x 156"L <b>204X204</b> 204"W x 204"L	<b>LED</b>	<b>Blank</b> Downlight (std.) <b>1U2D</b> Uplight and Downlight	<b>Downlight</b> <b>60X60 in.</b> <b>80</b> 80 Watts 9200 Lumens <b>108X108 in.</b> <b>160</b> 160 Watts 18400 Lumens <b>156X156 in.</b> <b>240</b> 240 Watts 27600 Lumens <b>204X204 in.</b> <b>320</b> 320 Watts 36800 Lumens <b>1 Up and 2 Down Only</b> <b>60X60 in.</b> <b>128</b> 128 Watts 5520U-9200D <b>108X108 in.</b> <b>256</b> 256 Watts 11040U-18400D <b>156X156 in.</b> <b>384</b> 384 Watts 16560U-27600D <b>204X204 in.</b> <b>512</b> 512 Watts 22080U-36800D	<b>DMV</b> 120-277V Multivolt 0-10V Dimmable  <b>DMV11</b> 0-10V Dimming Separate drivers for uplight and downlight

8. FINISH <sup>3</sup>	9. LENS	10. CRI	11. COLOR TEMP	12. FLAIR <sup>4</sup>	13. EM (O) <sup>6</sup>	14. CONFIGURATION
<b>BK</b> Black <b>SI</b> Silver <b>WH</b> White	<b>FR</b> Frosted Acrylic Lens (85% transmission)	<b>Blank</b> 80 <b>9</b> 90	<b>30</b> 3000K <b>35</b> 3500K <b>40</b> 4000K <b>50</b> 5000K	<b>RD</b> Red <b>BL</b> Blue <b>BK</b> Matte Black	<b>EM14</b> 14W Emergency Battery Backup <sup>5</sup>	<b>-CR</b> Cross

**Notes:**

<sup>1</sup>Cross configurations are measured by an overall system width and length.

<sup>2</sup>Wattage and lumen values are total for the system. Minimum fixture wattage of 10W. Minimum 5W per fixture foot uplight and downlight. Maximum 7W per fixture foot uplight and 14W per fixture foot downlight. Power feed cable is 18AWG, power drop is required every 800W or 48 feet for 0-10V dimming, whichever comes first.

<sup>3</sup>Consult for custom finish options

<sup>4</sup>Consult for custom flair options

<sup>5</sup>Emergency battery backup is integrated in fixtures 4' and longer, but is not available in fixtures 4' and shorter if uplight and downlight are used.

<sup>6</sup>(O) is optional

Dimensions and specifications subject to change without notice.



JOB NAME:

CAT#:

TYPE:

**FLAIR BRACKET COLORS AND FINISHES**



Gloss Black  
(GB)



Matte Black  
(BK)



Matte Silver  
(SL)

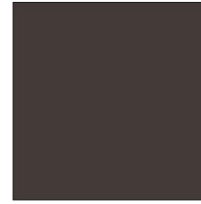

Statuary Bronze  
(BZ)

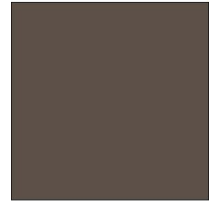

Glimmer (Iron)  
(IR)

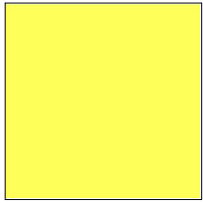

Safety Yellow  
(YL)

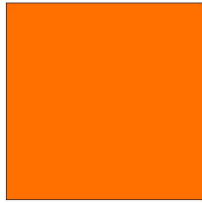

Safety Orange  
(OR)



Red  
(RD)



Fire Engine Red  
(FR)



Blue  
(BL)

**NOTE:** Factory offers any Tiger Drylac RAL finish, contact Saylite for more information. Consult factory for information on specialty "real wood" finishes.

Dimensions and specifications subject to change without notice.



JOB NAME:

CAT#:

TYPE:

**APPLICATIONS**

**Custom**

Make a statement in your space with a number of configurations of our PGN23 (polygon 2"x3") series hanging luminaire system, including custom ones of your own making. Whether developing your own custom pattern of L23 fixtures or choosing from multiple standard patterns, the PGN23 series delivers with elegance and distinction.

Custom Polygon Series options are achievable via brackets that can be set to nearly any angle, for almost infinite possibilities adjoining L23 fixtures in creative ways. These fixtures cast uplight and downlight for bright and efficient illumination. Get inventive to make your space your own.

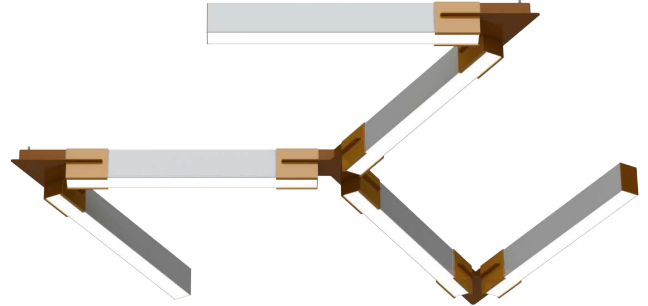

**FEATURES & BENEFITS**

- 4 standard fixture sizes – 24", 48", 72", and 96"
- Customizable bracket colors available
- Pendant mount for most ceilings
- Many lumen package / wattage options via programmable drivers
- CRI >80 (90 CRI available)
- >50,000 hrs of L70 LED life
- Power factor >0.90

**BRACKET DIMENSIONS**

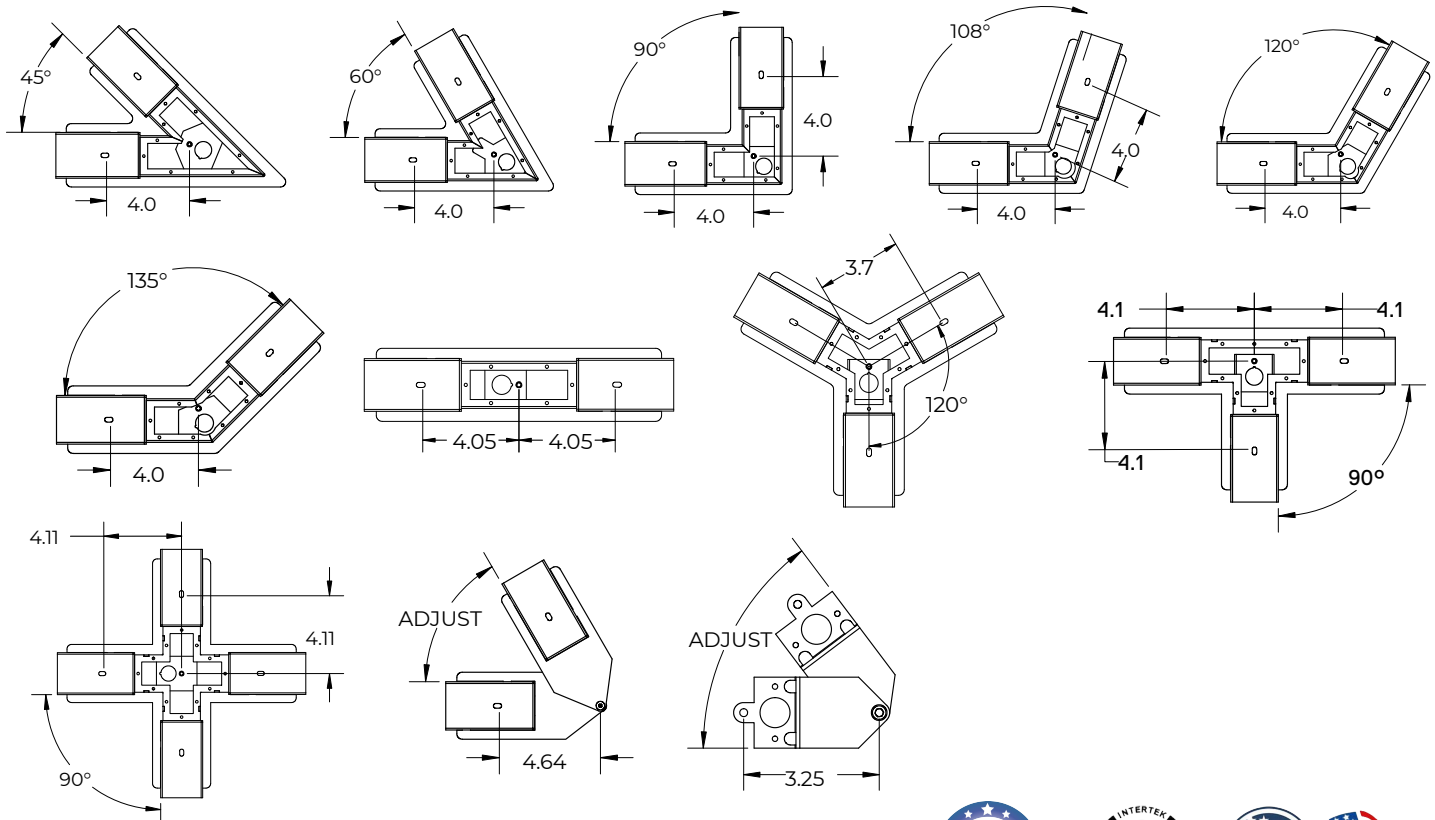

Dimensions and specifications subject to change without notice.





JOB NAME:

CAT#:

TYPE:

**CUSTOM CONFIGURATION PATTERNS**

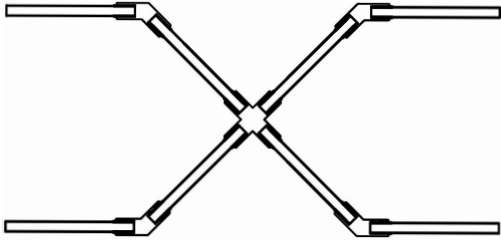

01 - Extend

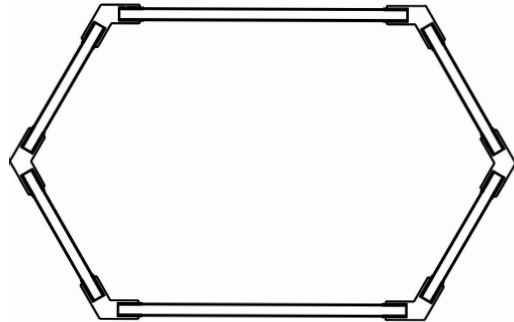

02 - Expanded Hex

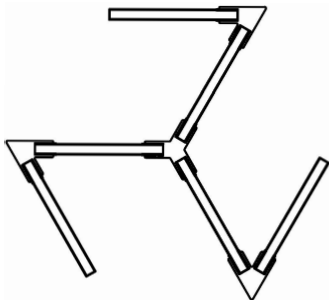

03 - Isle

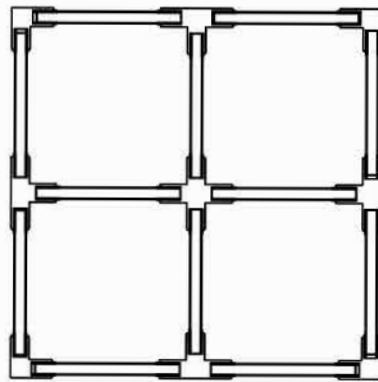

04 - Pane

**\*NOTE:** These patterns represent only a handful of patterns that can be made using the PGN23 system. Contact a Mobern representative for more information about creating your unique pattern.

Dimensions and specifications subject to change without notice.



JOB NAME:

CAT#:

TYPE:

**FLAIR BRACKET COLORS AND FINISHES**



Gloss Black  
(GB)



Matte Black  
(BK)

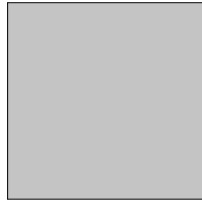

Matte Silver  
(SL)

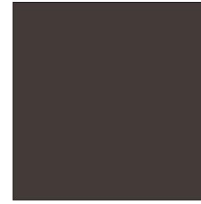

Statuary Bronze  
(BZ)

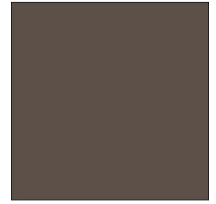

Glimmer (Iron)  
(IR)

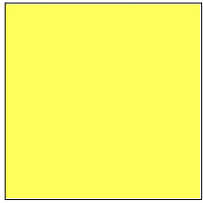

Safety Yellow  
(YL)

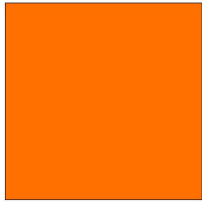

Safety Orange  
(OR)



Red  
(RD)



Fire Engine Red  
(FR)



Blue  
(BL)

**NOTE:** Factory offers any Tiger Drylac RAL finish, contact Saylite for more information. Consult factory for information on specialty "real wood" finishes.

Dimensions and specifications subject to change without notice.